

Belmont Avenue, Palmers Green, N13 4HD

£1,850 pcm



Full Description

Williamson Dace Brown is pleased to present this two-bedroom ground floor flat in N13, Palmers Green. The property comes with one double bedroom and one single bedroom, separate modern kitchen, living area and bathroom. Further benefits include private garden. The property is within walking distance to all local amenities and transport links with access to Palmers Green Station with direct trains to Finsbury Park and Moorgate Station. Available Now. **Features:**

- Two bedrooms
- Modern kitchen
- Private garden
- Council tax band D
- Unfurnished
- White goods included

* Has the property been flooded in the last 5 years? No * Is there a risk of flooding? No * Is the property listed? No * Is the property in a conservation area? No * Are there any public rights of way across the property? No * Council Tax Band - D * Property Type - Flat * Property Construction - Brick * Parking – On Street Utilities / Services Electric Supply - Mains. Gas Supply – Mains Water Supply - Mains. Sewerage - Mains. Heating sources – Gas Central Heating Broadband Connected - Yes. Broadband Type –

Full Fibre Broadband Mobile Signal/Coverage - Likely with EE, O2 and Vodafone

Contact Us

Williamson Dace Brown

22 Cannon Hill, London

N14 6BY

T: 0208 886 4407

E: alex@wdbproperty.co.uk



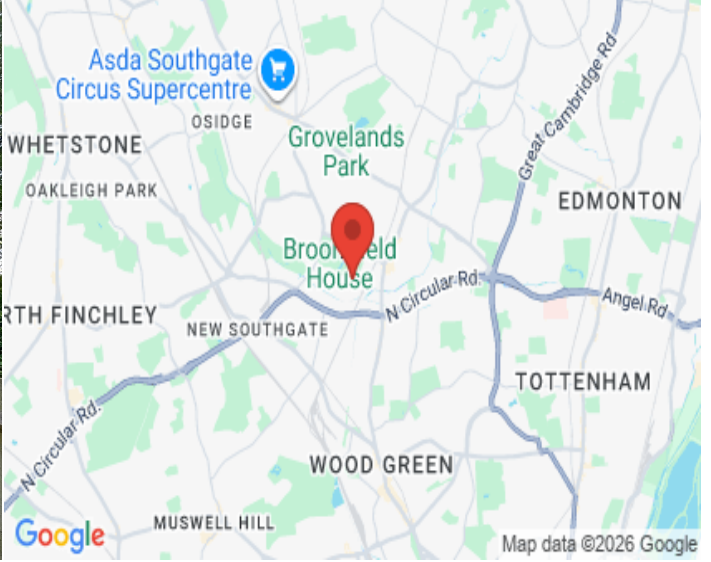

Approximate Floor Area = 79.1 sq m / 851 sq ft
(External Sheds)

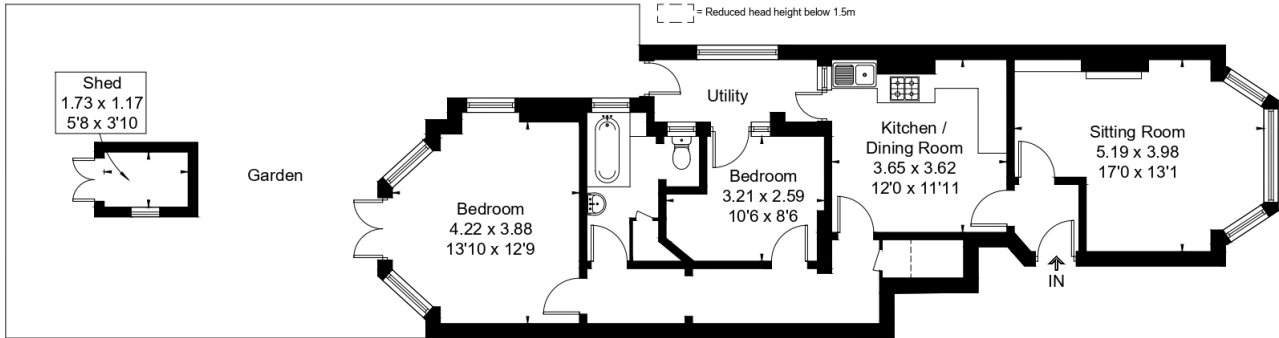

Ground Floor



This floor plan has been drawn in accordance with RICS Property Measurement 2nd edition.
All measurements, including the floor area, are approximate and for illustrative purposes only. @fourwalls-group.com #107014